

**AMP NETCONNECT(*): AMP-TWIST(*) 6AS Stnd SL Jack
PN 2153000-[] & 2153001- []**

AMP-TWIST(*) 6AS Stnd SL Jack, PN: 2153000-[] / 2153001-[]	CABLE REQUIREMENTS (Product spec.108-93044)	TOOL, PN: 1725150-3												
<p>Front Housing Rear Housing</p> <p>CAT 6A</p> <p>XG 10 Gb/s approved</p>	<table border="1"> <tr> <td>Solid conductor range</td> <td>AWG 22-24</td> <td>✓</td> </tr> <tr> <td>Stranded conductor range</td> <td>AWG 24-26</td> <td>✓</td> </tr> <tr> <td>Insulation Ø (mm.) range</td> <td>0.8 – 1.6</td> <td>✓</td> </tr> <tr> <td>Cable Ø (mm.) range</td> <td>5.0 - 9.0</td> <td>✓</td> </tr> </table>	Solid conductor range	AWG 22-24	✓	Stranded conductor range	AWG 24-26	✓	Insulation Ø (mm.) range	0.8 – 1.6	✓	Cable Ø (mm.) range	5.0 - 9.0	✓	<p>Scale Foil cutter Cable strip hole</p>
Solid conductor range	AWG 22-24	✓												
Stranded conductor range	AWG 24-26	✓												
Insulation Ø (mm.) range	0.8 – 1.6	✓												
Cable Ø (mm.) range	5.0 - 9.0	✓												

CABLE PREPARATION: S/FTP ("PiMF")

S/FTP

50 mm. aprox.

10 mm. aprox.

10 mm. aprox.

Metal Braid

TOOL PN 1725150-3

NOTE

Dimensions are in mm. Figures are for ref. only

CABLE PREPARATION: F/FTP ("Compact")

F/FTP

50 mm. aprox.

10 mm. aprox.

10 mm. aprox.

TOOL PN 1725150-3

NOTE

Dimensions are in mm. Figures are for ref. only

CABLE PREPARATION: F/UTP

F/UTP

50 mm. aprox.

10 mm. aprox.

10 mm. aprox.

10 mm. aprox.

TOOL PN 1725150-3

NOTE

Dimensions are in mm. Figures are for ref. only

ASSEMBLY INSTRUCTION

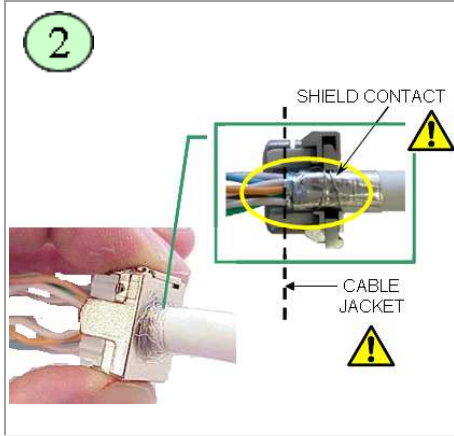
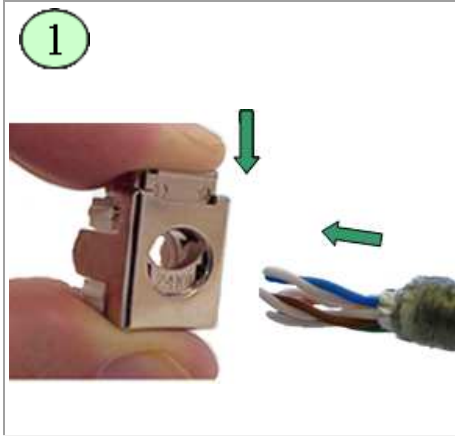

3

NOTE

i

> The metal braid (S/FTP), metal foil (F/FTP & F/UTP) and drain wire (if any) must be in contact with the clamp.

> Keep wire pairs twisted as much as possible.

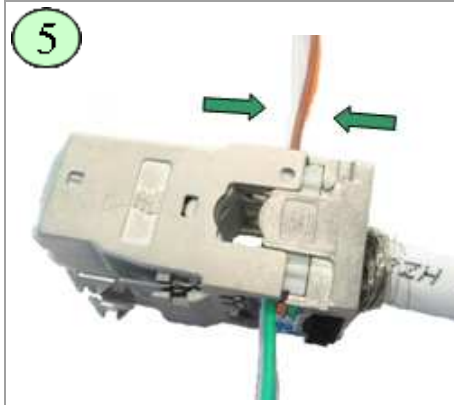
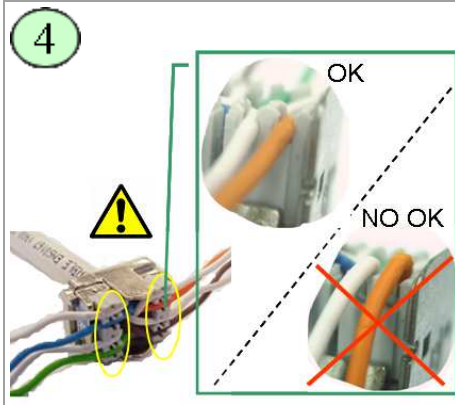

6

NOTE

i

Open dust cover (If any)

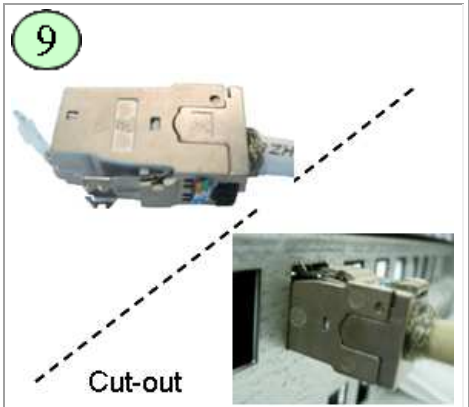
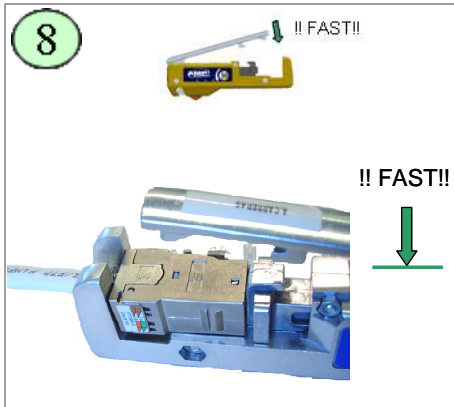
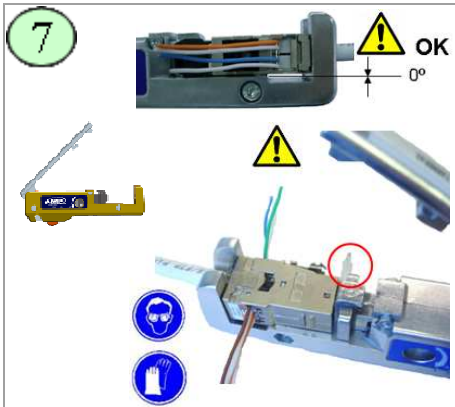

RE-OPENING INSTRUCTION

